

Corporate Meetings & Events

Every event is personalised to suit each client. We look forward to hosting your next significant occasion.

Otaihuna Lodge offers an exceptional venue for a variety of activities from a board meeting or private dinner to a complete takeover for the ultimate corporate retreat or incentive group. The 30 acre property offering seven exquisite suites provides guests with the quintessential lodge experience, featuring special amenities and personalised service in the environment of New Zealand's most important historic estate. The Otaihuna team will work to ensure a seamless experience that ensures your every need is met for a most memorable event.

Allow us to prepare a diverse activities programme including:

- Heli-touring from the Lodge's Great Lawn
- Akaroa and its stunning volcanic harbour
- Arthur's Pass National Park and the TranzAlpine Scenic Railway
- Demonstration cooking lessons
- Guided tours of the property's historic and productive gardens



The Ballroom

A beautifully panelled wooden vaulted ceiling and hand-carved trefoils and quatrefoils are striking features of this sun-streamed room. The space can accommodate up to 64 for private events. Terrace doors open out to the verandah, an ideal spot for morning tea or an afternoon cocktail.

Room Capacity	Board Room	U Shape	Theatre
64	30	25	70

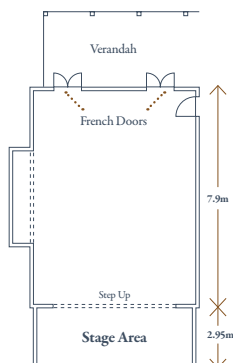

The Drawing Room

A favourite area in which to retreat, the Drawing Room is set off by crisp robin's egg blue furnishings, a spectacular hand-carved fireplace mantle and a matching custom-designed sideboard. For private retreats and exclusive use conferences the Drawing Room can be re-purposed to provide a convivial lounge atmosphere for open discussions.

Lounge Seating	Theatre
16	36

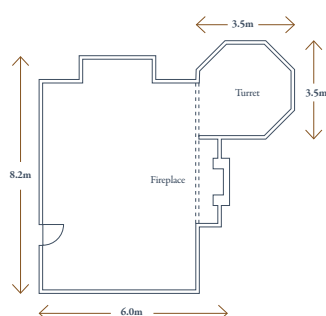

The Dining Room

The formal Dining Room can seat up to 14 for a grand dinner. A rich and resplendent room with original gilded wallpaper, a roaring fire and sparkling candlesticks, it recreates the gracious lifestyle of a bygone era.

Room Capacity	Board Room
14	14

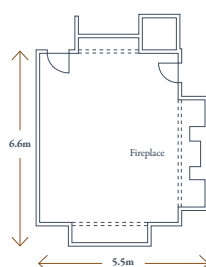

You'll Be Here In No Time

Otahuna Lodge is located at the head of a secluded valley on New Zealand's South Island, 25 minutes drive from Christchurch International Airport and Christchurch city.

By Car

Arthur's Pass - 2 hours
West Coast - 3.5 hours
Blenheim - 4 hours
Nelson - 5 hours
Wanaka - 5 hours
Queenstown - 6 hours

By Air

Queenstown - 45 minutes
Wellington - 45 minutes
Auckland - 1.5 hours
Napier - 1.5 hours
Sydney - 3.5 hours
Melbourne - 3.75 hours

Helipad on site

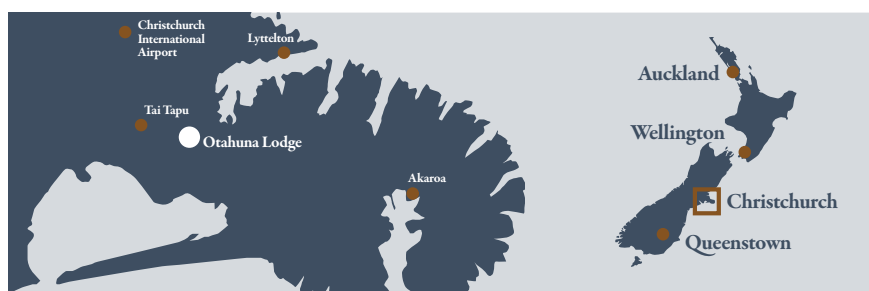

Otahuna Lodge, 224 Rhodes Road, Tai Tapu 7672, Christchurch, New Zealand
Phone +64 3 329 6333 Email enquiries@otahuna.co.nz

www.otahuna.co.nz

